

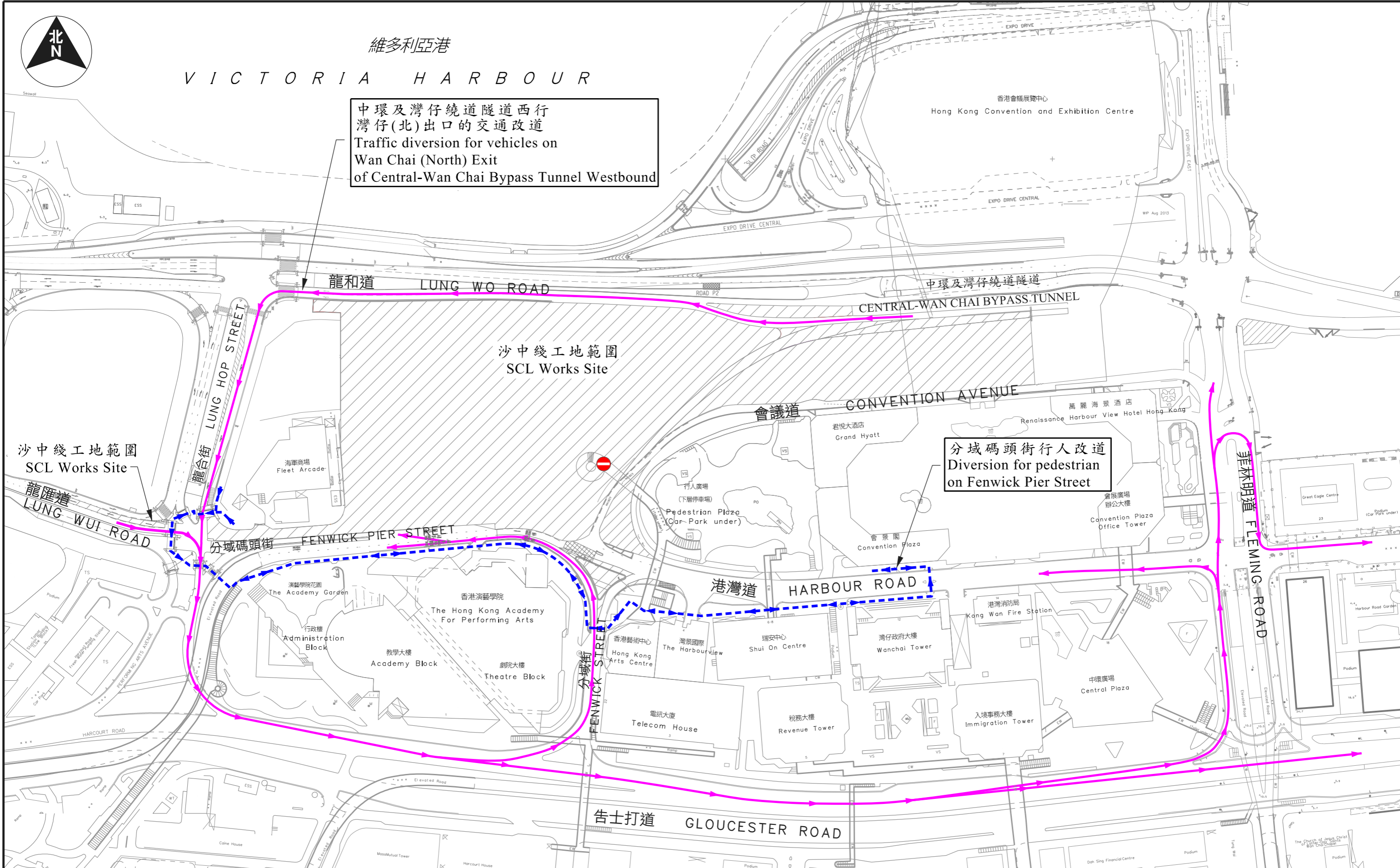

維多利亞港

VICTORIA HARBOUR

中環及灣仔繞道隧道西行
灣仔(北)出口的交通改道
Traffic diversion for vehicles on
Wan Chai (North) Exit
of Central-Wan Chai Bypass Tunnel Westbound



沙中綫工地範圍
SCL Works Site

沙中綫工地範圍
SCL Works Site

分域碼頭街行人改道
Diversion for pedestrian
on Fenwick Pier Street

附圖一
Fig.1

灣仔北及中環及灣仔繞道隧道(西行)交通安排 -
由2021年11月28日凌晨零時起至凌晨3時止
Traffic Arrangements in Wan Chai North and Central-Wan Chai Bypass Tunnel Westbound -
From 12.00 midnight to 3.00 am on 28 November 2021

